

For weatherboard fixing please refer to our fixing details for the specific type of board

Weatherboards this side to run through to stud and to be fixed first

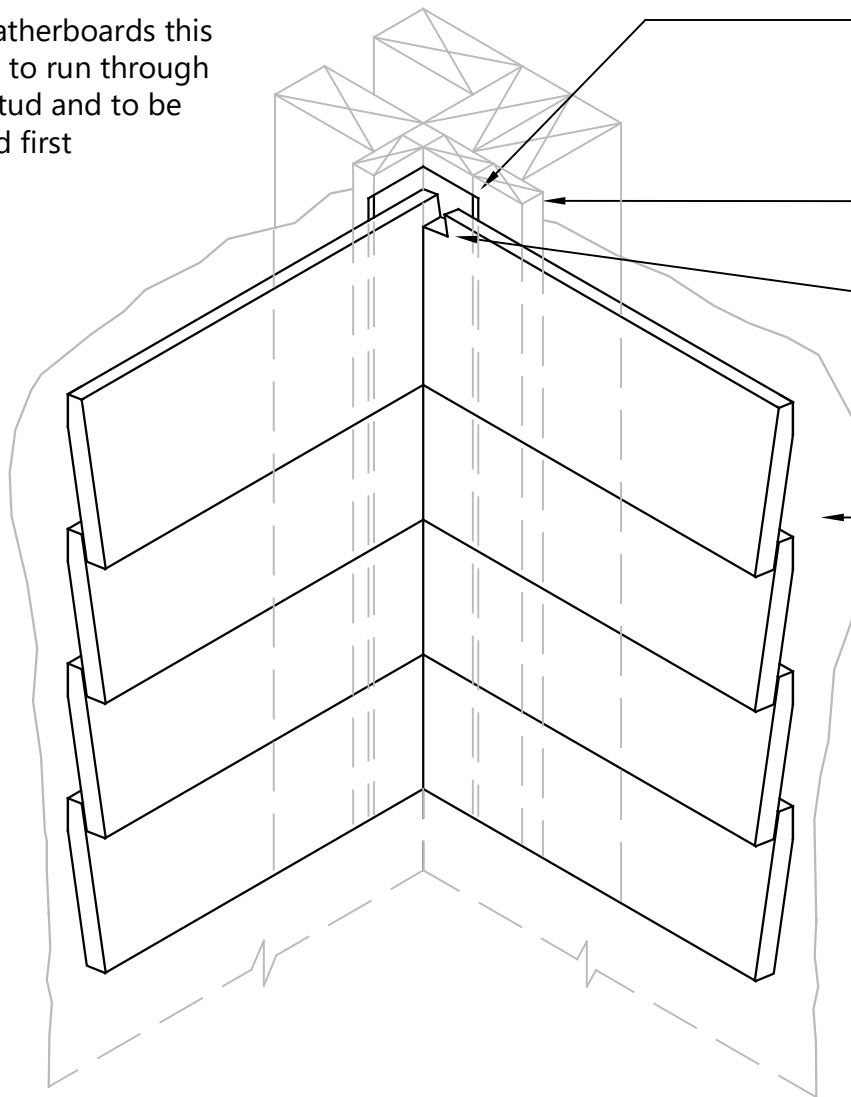

Back flashing
hemmed at ends

SPP Cavity Batten
CBAT 45x20

Accurately notch top of
weatherboard this side
to match incoming
weatherboard above

Building wrap

Weatherboards this side
to be scribed into other
weatherboard. Prime and
seal joint between boards
with sealant.