

# Lock Connect

The new, extremely easy-to-use combined installation system.

The new Lock Connect system for HARO PARQUET cleverly combines the advantages of the previous HARO installation systems, and is fast and easy to install.

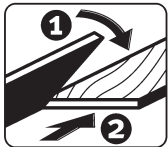

The boards are angle engaged on the long sides (1), and then clicked together horizontally on the short sides (2).

**HARO**  
PARQUET



**Glueless  
instalation**

## 1 Angle engaged on the long side and press downwards



## Lightly tap with tapping block if required



## 2 Short side horizontally clicked



## 3 Installation tip



An easy trick to ensure a smooth interlocking of the boards at the short sides is to temporarily angle a leftover board piece into the two boards you want to click together.

## 4 Stepped installation technique

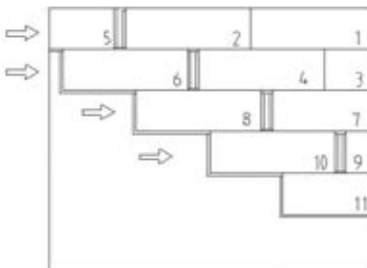

Another way to install Lock Connect is the stepped installation technique: First join the boards of several rows at the long sides only, starting in the right-hand corner of the room. Then click the boards together at the short sides by using hammer and tapping block. Proceed in the same way to install the remaining rows. See drawing for the sequence of installation.

### HARO Lock Connect:

- ⊕ Uniform installation system for HARO PARQUET, Laminate, Veneer and Cork Flooring as well as HARO Linoleum Parquet
- ⊕ Even easier to use
- ⊕ Even faster to install
- ⊕ Installs free-floating – no wall or fixed object required as starting point
- ⊕ Perfect installation also under radiators and door frames
- ⊕ Glue-down installation possible for contract projects, if required